

Memo:

To: Board of Selectmen

From: Transportation Advisory Committee

Subject: Recommendations for the Intersection at Jason and Spring
Streets

Date: 23 September 2002

Issues:

- a. A school bus stop across Spring Street by the MWRA pumping station requires children to cross the prevailing traffic.
- b. The turn from Jason onto Spring heading to the Concord Turnpike and from Spring Street onto Jason is difficult and dangerous because of the configuration. Accidents have recently occurred at this intersection.

The Transportation Advisory Committee recommends the following actions to the Board of Selectmen relative to the referenced intersection:

1. **Install a crosswalk** across Spring Street, near school bus stop, with appropriate pedestrian warning signs.
2. **Place yellow center lines** at the bottom each of Jason and Pleasant View, proceeding only about 60 ft up from the intersection.
3. **Place yellow center lines** on Spring between Jason and the Concord Turnpike entrance.
4. **Install Stop Signs** at the bottom of Jason and Pleasant View.

Other potential changes were also discussed, which would require more than paint and signs. It is recommended that the above actions be implemented and observed before considering more extensive work.

(Before and after illustrations are attached)

ROUTE 2

ROUTE 2 ACCESS

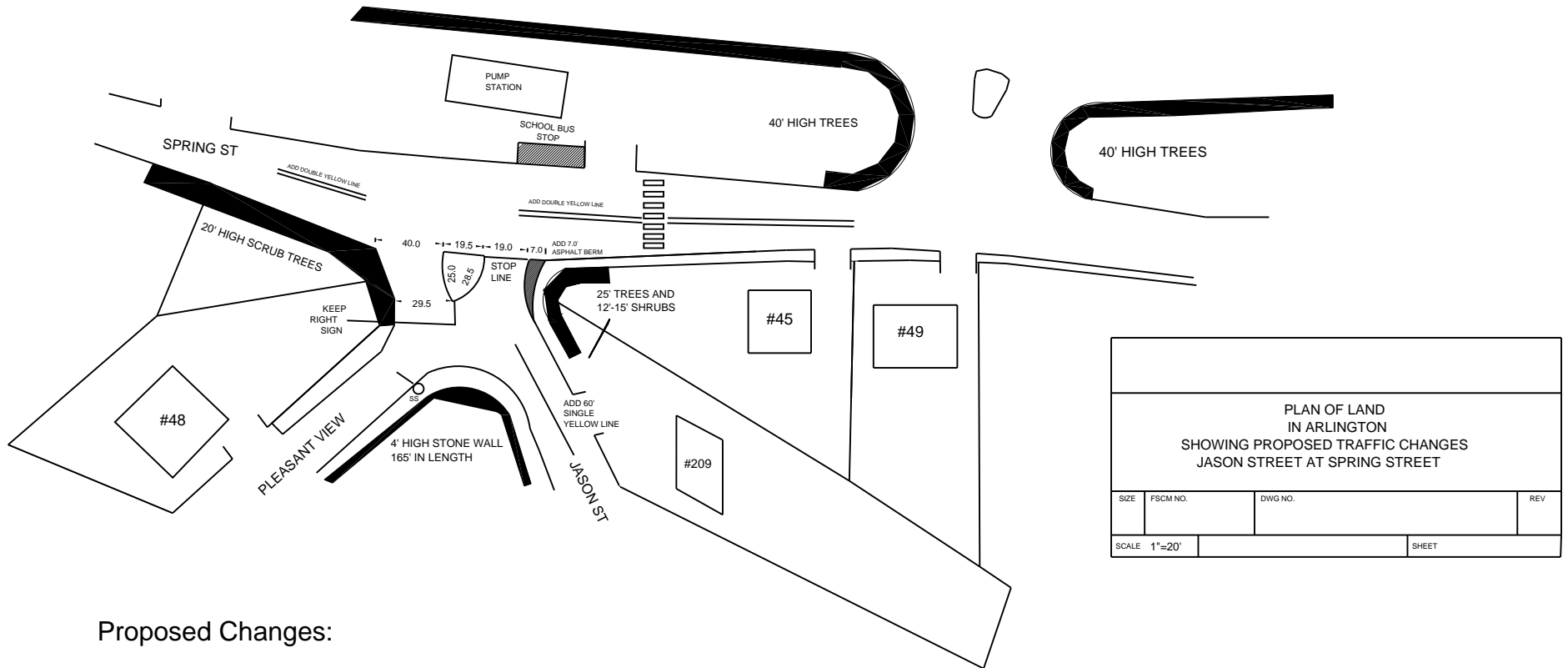

PLAN OF LAND IN ARLINGTON SHOWING PROPOSED TRAFFIC CHANGES JASON STREET AT SPRING STREET			
SIZE	FSCM NO.	DWG NO.	REV
SCALE 1"=20'			SHEET

Proposed Changes:

- Installation of crosswalk on Spring Street
- Installation of asphalt berm traffic island
- Relocation of Jason Street stop sign
- Narrowing of intersection at Jason Street
- Installation of traffic island signage
- Application of centerline pavement markings