

**TOWN OF ARLINGTON**  
**Purchasing Department**  
730 Massachusetts Avenue  
Arlington, MA 02476  
Telephone 781.316.3003

**March 6, 2026**

**Invitation for Bids #26-01**  
**Playground Renovation – Thompson Elementary School**

**ADDENDUM NO. 2**

The attention of bidders submitting bids on the above-referenced project is called to the following Addendum to the Invitation for Bids. The items set forth herein, whether of omission, addition, substitution, or clarification, shall be included in and form a part of the proposal submitted and shall become part of the Contract.

**Clarifications**

1. The Star benches shall be filled with sand and placed free-standing in the locations shown on the drawings.
2. Picnic tables will have an umbrella hole; the umbrellas shall be mounted to the base through the picnic table umbrella hole opening.

**Drawing Change**

1. The play space with the multi-goal will not have any surfacing pattern. See attached Drawing L200, revised as of March 3, 2026.

**Specification Changes**

1. Invitation to Bid, para. 1.08, second sentence, change “45 calendar days” to “60 calendar days” and change “60 calendar days” to “75 calendar days”.
2. Summary of Work, Section 01 11 00, para 1.03 (A) (7), change “90 days” to “60 calendar days”.
3. Summary of Work, Section 01 11 00, para 1.03 (A) (8), change “120 days” to “75 calendar days”.

**List of Persons Attending Pre-proposal Conference**

Aarron Forte, Forte Landscape and Construction Company

All other terms and conditions of the Invitation for Bids remain unchanged.

**Bidders are advised to acknowledge this addendum on the bid form. Failure to acknowledge any or all addenda could result in rejection of the bid as non-responsive.**

James Feeney  
Town Manager

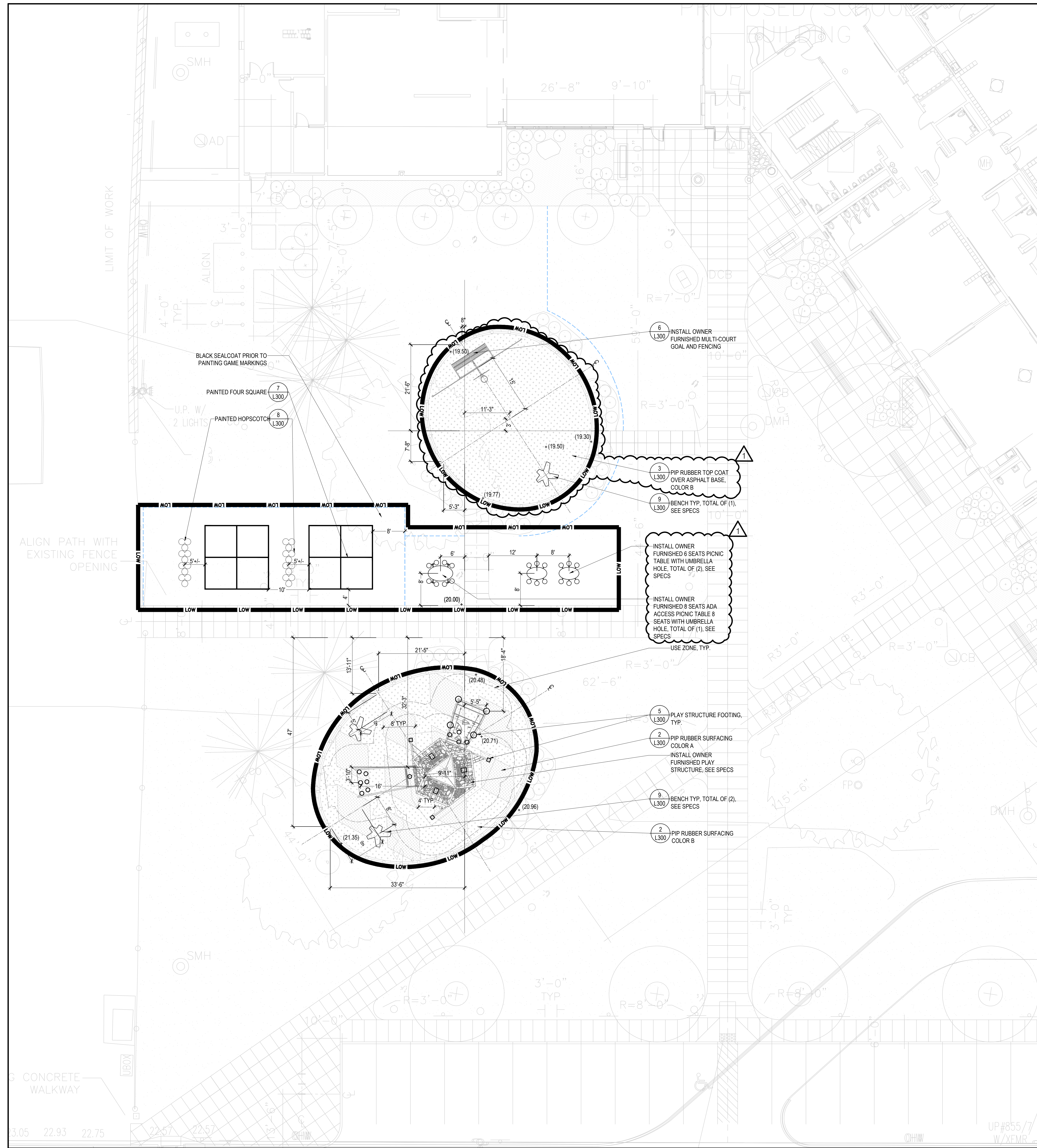

**MATERIAL NOTES:**

1. CONTRACTOR SHALL VERIFY ALL CONDITIONS IN THE FIELD AND REPORT ANY DISCREPANCIES TO THE LANDSCAPE ARCHITECT PRIOR TO STARTING WORK.
2. CONTRACTOR SHALL NOTIFY DIGSAFE 1-888-DIGSAFE AND VERIFY UNDERGROUND UTILITIES PRIOR TO EXCAVATION.
3. CONTRACTOR IS RESPONSIBLE FOR REPAIRING ANY DAMAGE CAUSED TO ROADS, WALKS, UTILITIES, SITE IMPROVEMENTS, EXISTING OR PROPOSED, DAMAGED BY THIS PROJECT.

**LAYOUT NOTES:**

1. ALL LINES AND DIMENSIONS ARE PARALLEL OR PERPENDICULAR TO THE LINES FROM WHICH THEY ARE MEASURED UNLESS OTHERWISE NOTED.
2. THE DIMENSIONS SHOWN ON THE DRAWINGS SHOW DESIGN INTENT AND MUST BE FIELD VERIFIED PRIOR TO PREPARATION OF SHOP DRAWINGS.
3. PROVIDE EXPANSION JOINTS IN CONCRETE WALKS AT 30' O.C. AND CONTROL JOINTS AT 10' O.C. AS PER SPECIFICATIONS, UNLESS OTHERWISE INDICATED ON DRAWINGS.
4. ALL CURVES SHALL BE SMOOTH, CONTINUOUS RADII. NO STRAIGHT SECTIONS OR ABRUPT TRANSITIONS.
5. CONTRACTOR SHALL STAKE OUT ALL IMPROVEMENTS TO BE APPROVED BY THE LANDSCAPE ARCHITECT PRIOR TO INSTALLATION.

**LEGEND:**

- APPROXIMATE LIMIT OF WORK LINE
- BASE BID; SINGLE COLOR PIP RUBBER TOP COAT OVER ASPHALT BASE OR PIP RUBBER SURFACING
- BENCH
- PICNIC TABLE
- (19.77) EXISTING SPOT GRADE

REVISIONS		
NO.	DATE	DESCRIPTION
1	26/03/05	ADDENDUM 1

DATE: 02-18-2026  
SCALE: 1"=20'  
JOB #: 26-01  
DRAWN BY: YW  
CHECKED BY: DW

**MATERIALS LAYOUT  
GRADING PLAN**

L200

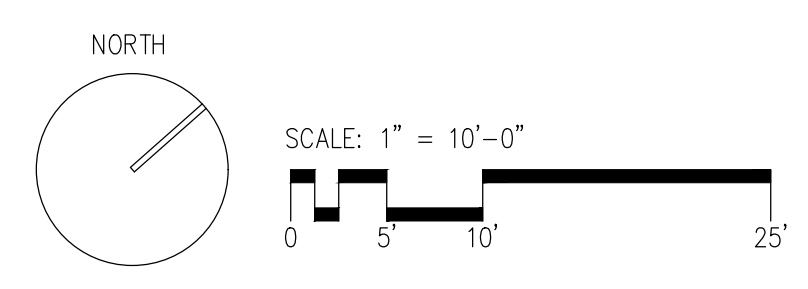

BASE PLAN IS FROM THE ORIGINAL SCHOOL PROJECT DRAWINGS.  
CONTRACTOR TO VERIFY EXISTING CONDITIONS INFORMATION IN THE  
FIELDS

3.05 22.93 22.75 22.57 22.57

UP#855/7  
W/XFMR